

Load extender



The **load extender VGT** enables loading from one side of the vehicle. Its stable construction minimises service life cost. The original standard fork arms can be used.

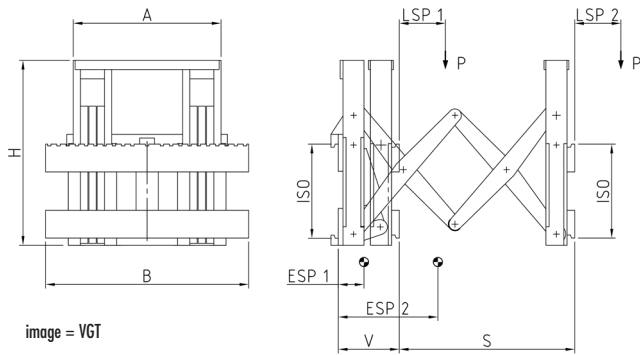

image = VGT

without sideshift												
type	capacity retracted P kg LC 1/LSP 1 mm	capacity extended P kg LC 2/LSP 2 mm	lift truck to LC mm	ISO back/ front	B mm	A mm	H mm	stroke E mm	V LLC mm	ESP 1 COG 1 mm	ESP 2 COG 2 mm	weight kg
VGT 25	2500/600	1150/1450	2,5/600	II	980	800	1000	950	340	154	546	605
VGT 35	3500/600	1300/1450	3,0-3,5/600	III	1100	800	1000	950	348	164	610	655

- 1 hydraulic function required
 - includes hoses and couplings
- can also be supplied with 1200 mm stroke to your choice
 - forks not included

with constant sideshift													
type	capacity retracted P kg LC 1/LSP 1 mm	capacity extended P kg LC 2/LSP 2 mm	lift truck to LC mm	ISO back/ front	B mm	A mm	H mm	stroke E mm	sideshift mm	V LLC mm	ESP 1 COG 1 mm	ESP 2 COG 2 mm	weight kg
VGT 25-S	2500/600	1150/1450	2,5/600	II	980	800	1000	950	+/- 100	355	150	620	668
VGT 35-S	3500/600	1300/1450	3,0-3,5/600	III	1100	800	1000	950	+/- 100	360	165	635	695

- 2 hydraulic functions required
 - includes hoses and couplings
- can also be supplied with 1200 mm stroke to your choice
 - forks not included

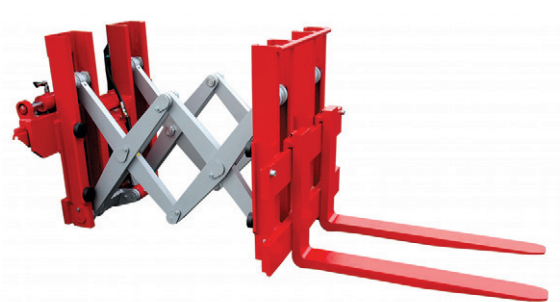

image shows type VGT-S with optional hook-on forks

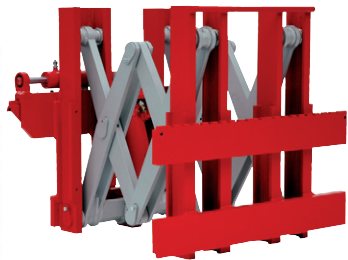

image shows type VGT-S



More than 75 years experience